

Introduction

Evergreen Lutheran High School has always been a place full of sinners. The Dupont era was full of sinners. The Kent years were full of sinners. Peruse the history of Evergreen and you will see students, parents, faculty, board members, Association members and churches all going their own way. There was drinking, drugs, lack of support, lack of caring, scapegoating, self righteousness, selfish priorities and much more. In fact I challenge you to find one good person who has been involved with Evergreen in some way. You can't, you'll only find sinners.

Evergreen Lutheran High School has always been a place full of saints. The early years are wonderful years filled with holy ones who gave themselves to the work of the Lord fully confident of His help and blessing. The later years were more of the same. Students faithfully using their talents to glorify God. Parents, Association members and the churches all putting the Lord first in their lives. The faculty were saints who reflected God's glory and proclaimed His deeds in their classes and in their lives. In fact I challenge you to find anything wrong with the saints at Evergreen. You can't! They are holy ones of God.

Evergreen Lutheran High School has always been a place full of sinners who are at the same time saints. In this short history of Evergreen I believe you will see many sinners/saints. That is the history of Evergreen as it is the history of the Christian Church on earth. But if that is all you see then you have missed the point of human history. Human history is not about great people but our great and gracious God. The history of Evergreen is about our God who is faithful to His word, compassionate to the weak and powerful to those in distress. He opens his hand and provides us with all we need for body and soul. He crowns our lives with His love and pours out His Spirit upon us. He has ripped open the jaws of death and destruction and brought us safely into the arms of life and joy. The history of ELHS is the history of our Lord Jesus showering us with blessing and grace and love. May He receive all glory, praise, honor, dominion and power both in this age and in the age to come!

--Joe Johnson April 24, 1998

1970-1975 Early Dreams

"Here I am, living in a palace of cedar, while the ark of God remains in a tent." -2 Samuel 7:2

It had been many years since David could take a time out and look around. After he was anointed by Samuel his life was changed. There were the years in Saul's service as a musician and after Goliath as a warrior. Then there were the hard years of being a fugitive. David was hunted by the very king he faithfully served. When Saul finally was destroyed David was made king of Judah and years later king of Israel. Things were looking up, Jerusalem was captured a capital was established and the ark moved into the city. Finally the Lord had given David rest from his enemies and David could take some time to evaluate his situation.

Isn't that the case in our lives? At times we can become so busy in the day to day that our whole life seems to flow from one project to another or one problem to another. When David was given a chance to look around he realized that he was living in a nice palace while the ark was in a tent. It didn't seem right. Something was wrong with the picture and David was going to correct it. David had a dream. His dream was to build a temple for the Lord. He wanted to build a place worthy of his God. A place where the saints could gather to worship and praise the Lord. That dream pleased the Lord and David was allowed to plan and prepare but not

build a house for the Lord. It was the will of the Lord that David's son Solomon would finally build the temple that was in David's heart to build.

Evergreen was such a dream. Even before the Lord gave "rest" while many of our congregations were just missions people began to evaluate. We are starting churches. We are planting grade schools. But what about our teens? What can we do to draw them to the Lord at this most critical stage of life? Are public high schools the only or best option? It didn't seem right. Something was wrong with the picture. It could be better! With that in mind the idea or dream of a Lutheran high school began. A dream that in God's good time became what we know and love as Evergreen Lutheran High School.

One of the early expressions of the dream was in 1970 at the Lutheran Education Forum hosted by Lakewood Lutheran Church. This education forum was focused on the possibility of a high school. Some of the topics that were presented and discussed were: How a Lutheran High School Started, Promotional Efforts Needed to Start a High School, High Schools of the WELS.¹ There was even a High School Planning Committee made up of fourteen individuals from four congregations. I think you'll recognize many of the names listed.

¹Bulletin Lutheran Education Forum

Faith Lutheran (WELS)

Rev. Melvin F. Teske
Mr. William Habermann
Mr. George Egerter
Mr. Victor Ellenberger

Lakewood Lutheran (ELS)

Rev. William F. McMurdie
Mr. Andrew Bilich
Mr. Wayne Hooper
Mr. John Young

St. Paul's Lutheran (WELS)

Rev. George Frey
Mr. Albert Rakos

Parkland Lutheran (ELS)

Rev. Hans A. Theiste
Mr. Larry Joecke
Mr. Herbert Cronk
Mr. Albert J. Langseth²

The seed that was planted in those early days began to grow. More and more of God's people saw the need for a Christian high school in the Northwest. In 1973-74 the seed sprouted and the dream became the Pacific Northwest Lutheran High School Association (Here after referred to as PNLHSA or the Association). The idea for an Association seems to have been conceived in 1973³ but given birth in 1974. That was the year the constitution was completed and the first annual meetings were held. The purpose and dream of the young group was laid out very simply in the constitution (Appendix 1).

The purpose of this Association, a non-profit corporation organized under the laws of the State of Washington, shall be to establish, conduct, control, manage, and maintain one or more high schools in the Pacific Northwest District of the Wisconsin Evangelical Lutheran Synod and to promote the cause and extend the scope of Christian Education in keeping with the aim of the

²Bulletin Lutheran Education Forum

³Walden, Living Proof, page 1

Association.⁴

From the very beginning the Association was committed to opening a confessional high school that held to the word of God. For that reason membership in the Association was offered to all WELS members and those who were members of sister synods in fellowship with the Wisconsin Synod. The two synods listed were the Evangelical Lutheran Synod (ELS) and the Federation of Authentic Lutherans (FAL). But how do you organize an association in a district that stretches from Crater Lake to Mt. McKinley? The way they did it was to have a board of directors consisting of fifteen WELS men. (At this early point ELS members were not allowed on the board, that would change in 1979) There would be five men from each of the geographical areas of the Pacific Northwest District (Here after referred to in full or as the District). Five would come from Oregon/Idaho, five from Eastern Washington and the final five would hale from Western Washington and Alaska. Here is a list of the first Board of Directors.

First Board of Directors

Président: Rev. Paul Albrecht (Renton)
Vice Président: Thomas Marten (Yakima)
Secretary: William Haberman (Tacoma)
Treasurer: George Egerter (Puyallup)

⁴Constitution PNLHSA Article II

W. Washington

J. Schoeneck (Bellevue)
B. Walden (Bellevue),
One vacancy.

E. Washington

D. Butler (Yakima)
G. Nelson (Yakima),
Rev. A. Valerio (Yakima)
Rev. M. Teske (Yakima) At first annual meeting June 2, 1974
was replaced since as the Chairman of the District Board
for Parish Education he was already an Ex-officio
member of the Association Board.

John Pietrusiewicz (Kennewick) Replacement for Rev. Teske.

Oregon/Idaho

D. Baer (Portland)
A. Goodger (Bend)
J. Majovske (Tigard)
Rev. W. Widman (Portland)
Rev. E. Kahrs (Bend)⁵

This formation made for some interesting things. With three geographical areas came three separate meetings. There were three places, three devotions, three secretaries, but only one purpose! Each group would look at the issues and then would meet as a whole to bring it all together. A true blessing of this time is the unity of the three groups.

Once the PNLHSA was formed there needed to be a way to communicate to the wider membership of the Association and the District. This was first Accomplished by "News 'N' Notes" (At times listed as Notes "N" News) which was a mailing prepared by the Pacific Northwest District

⁵Minutes PNLHSA Annual Meeting 6-2-74

Board for Parish Education. In 1975 this was replaced by "News" a monthly PNLHSA newsletter and later called the "Update."

At the end of 1974 things were happening. People were excited. The word was getting out! Dreams were becoming reality and who knew the plans of the Lord? His blessings were obvious. By November 1, 1974 the young Association already had 131 member families numbering 520 souls from thirty different congregations. Grace Yakima led all with fifteen families followed respectively by Calvary Bellevue thirteen, Faith Tacoma twelve and King of Kings Kennewick with ten.⁶

In 1975 Pastor Arthur Valerio became the chairman of the PNLHSA, a post he held until 1978. He was also in charge of the "News" and was a great blessing throughout his years of service on the Board. By March 7, 1975 membership had increased to 170 families/602 souls.⁷ It is interesting to note the very strong leadership provided by Eastern Washington in these early years. Eastern Washington led all groups with twelve congregations/forty-five families/178 souls. The strong support of the ELS, two congregations/forty-five families/115 souls, is also notable. Western Washington had eleven congregations/forty-three families/168 souls and Oregon provided seven congregations/thirty-seven

⁶PNLHSA Membership Report 11-1-1974

⁷A Pacific Northwest Lutheran High School 3-31-75

families/141 souls for membership. Although the Association was still a small group there were many who were committed to their Lord and the children of the District. Many could agree with the following words of one layman.

I don't want to send my children to a public high school, exposing them daily for several hours to an increasingly non-Christian, -yes, even a blatantly anti-Christian atmosphere, in which they are taught by their class mates and by their teachers to forget or even ignore their parents and Savior. No, I must place them in a Christian High School where they will learn all things in the light of God's love for them. I will make sacrifices so that I can give special offerings toward a Lutheran High School close by for my dear children. I will think carefully about my luxury desires. Let's use the old car as long as we can; throw rugs will do as well as wall-to-wall carpeting; one TV in the house is enough; we do not need a camper. Instead of all those things, let's put the money we would have spent on them into the critical years for our children - the high school years. Could anything merit a truly sacrificial effort more than our own dear children?⁸

At this time we can also get a feel for the thoughts and spirit of the Association when we look at their first logo. The very first logo (See Appendix 2) was designed by Jon Schoeneck. It provided the PNLHSA with a visual symbol that could communicate the Association's purpose at a glance. It also made very clear that a Lutheran high school in the Northwest was not just a dream but a real goal perhaps realized in 1977.

In seeking a design, we tried to keep in mind the three geographical areas of the Association. If you look at the LOGO you

⁸News 12-75 "A Layman Thinks About His Offering"

will see these three areas: The pine tree represents Western Washington; the sun which shines so brightly represents Eastern Washington area; the 3 mountain peaks represent the 3 sisters of Oregon.

But more important than the physical representation of the logo is its message. The blackness of the tree shows forth the blackness of man's sinfulness. But there is a light at the end of the path. That light is the cross of Jesus Christ, the Sun of Righteousness. This is what we see as being the basis for Christian Education, leading and guiding young people on that path that leads to the cross of the Savior.

For the present, you will also find behind the logo a faint question mark, with the words FALL 77 printed behind and above the logo. That is inserted there to let all know that we are striving to reach the goal of opening the doors of our high school in the Fall of 1977. that is a goal. We hope and pray that we will be able to realize its fulfillment, but that, of course, depends entirely upon the blessings of God upon our efforts in His Name. ⁹

1976-1978 A School is Born!

New year's resolutions tend to be easy come, easy go. It is easy to start a new project, exercise program or diet. The problem comes when the excitement wears off and the daily struggle begins. It is one thing to eagerly start learning a foreign language but another to spend the hours of work and dedication it takes to actually learn the language. The members of the Pacific Northwest Lutheran High School Association were facing the same thing in 1976. The excitement and early beginnings were over and now the real work was beginning. How long would it take? Could it be

⁹News 9-75

done? Only the Lord knew.

There was discouragement in 1976. As of October there were 230 plus families in the Association but growth was very slow. Some months saw no new members to the PNLHSA at all. Already in March the Board of Directors were facing some hard financial facts. They decided two things. First they set the financial criteria for opening the high school.

We will need 2/3 of the needed contributions for the first year of operational costs in the bank and offerings for 3 consecutive months that come up to 2/3 of the needed monthly offerings for operation.¹⁰

And second they faced the hard truth that they could not open a high school in 1977. The first goal for opening a school could not be met.

No doubt the devil would have loved it if at this time the Christians would have lost heart, begun to blame each other and become divided. It didn't happen. At the beginning of the year the search was on for a location where a high school could be planted. Sites were looked at in the three geographical areas of the District. When it became apparent that it was not the Lord's will to open the high school in 1977 the Association by God's grace became even more united. A motion was made by the Eastern Washington delegation and seconded by the unanimous vote of the Oregon/Idaho group that Western Washington would be the prime target

¹⁰News 3-76

area for the new high school. This was a tough thing. It meant that once the school was started you had to send your kids away from home. Yet the decision was made because they felt it was the best for the kingdom.

They gave several reasons for their choice of location.

The reasons for this area over the other possibilities are: Largest number of youth; most Christian day schools; most enrollment in our schools; the probability of the largest number of commuting students; good transportation in and out of the area.¹¹

I think the members of the Association didn't give in or get discouraged because they believed so strongly in the vision. I believe the dream in the September issue of "NEWS" was held by many committed Christians throughout the District. I'm sure the faith/future looking words of this article were an expression of the hearts of many.

June ?, 19?? - that is an important date, as well as an historic date, for the members of the Pacific Northwest Lutheran High School Association. Why? Because that is the date that the very first class will graduate from our own District High School. Picture in your mind's eye the smiles of joy, happiness and accomplishment on the faces of the parents! The graduates know that the past four years were not easy years; there was more studying than what was expected and those foreign languages didn't come as easy as one had hoped. And while the frills of education were not there, the very basics were, and these were hammered home by a staff of God-fearing teachers, teachers who were concerned not only for the temporal and physical well-being of all the students, but teachers who were also most concerned with the spiritual life of every student. The graduates know that the education they have received was a Christ-centered, Christ-orientated education that would last

¹¹News 3-76

through time to eternity. The graduates join in singing the glorious words of the poet: "On Christ the solid Rock I stand, all other ground is sinking sand." Graduation day, June ?, 19??!

But now, lets shift our attention for a moment, from the graduates to the parents. We notice a special sort of gleam in their eyes too. Their looks betray a sense of satisfaction and accomplishment too. They are proud because they know that God has blessed the efforts that they had undertaken in His name. They remember the days when graduation was only a dream. They remember the time when their High School Association was first formed, and they remember the first meetings, when only a handful of concerned people were present. They remember seeing the membership in the Association grow. And perhaps some of them also remember the very first fall Rally that the Association had on that sunny day in August of 1976, that rally in which people from various areas of our District gathered at Vancouver to discuss the eventual opening of our High School. They remember how the membership of the Association worked together to make the Association grow because they knew that the more support they had, the sooner the High School would be a reality. They remember the many hours that they spent in prayer, seeking God's blessings on and His guidance to all their efforts. They remember how joy filled their hearts five years ago when they were told that all was now ready and that the Board was going to issue a Call for principal of the school. That joy was magnified four years ago when the first day of school was held for the 30 ninth graders. And now, the end of our dreams - our first Graduating Class!¹²

Little did the author know that in just two short years Evergreen Lutheran High School would open its doors!

Nineteen seventy seven was a year of preparation. It was a year when my mother a very hard worker began feeling very tired. As she worked under the hot Eastern Washington sun she noticed that she just didn't have as much energy as she used to. She started feeling sick.

¹²News 9-76

Finally after this persisted for a time she decided to go to the Doctor. It was quite a surprise when she was told that the Lord had blessed her with a new life. Our family was expecting a birth a new member in 1978. There was a lot of adjustments for father, mother and big brother and a great deal to get ready.

The Association was in for a similar surprise. The Lord in his wisdom had decided that it was time for the PNLHSA to become "pregnant" and start in earnest to get ready for the birth of a new high school.

The family that the school was coming into was growing. The Pacific Northwest District at the time was made up of 4,306 baptized, 2,933 communicants. The membership of the Association was 241 families equaling 900 souls. Parkland Lutheran Church (ELS) was the largest supporter with forty-eight families! Redeemer, Yakima a smaller congregation led all WELS churches with twenty families. By the end of the year the family had grown to 340 families consisting of 1,195 souls. Almost one hundred families were added in one year!

New children however need money. How was the financial situation of the family? The estimate for the first year expenses was \$61,500. Of that \$43,500 would need to be contributed. According to the financial criteria laid down by the Board of Directors the Association then needed

\$29,000 in the bank and to have raised over three months an average of 2,420 dollars. The problem was that at the end of 1976 the Association only had \$11,029.42 in the bank. But with the Lord's blessing the family of God pulled together to provide for the new school.

The Parkland Lutheran School under principal Larry O. Joecks gave their mission offerings for the new school. The first gift was \$80.00 and the second of the year was \$90.00. Another gift from a school came from outside the immediate family and was from our brothers and sisters at Wisconsin Lutheran College. In August their student body sent a gift of \$119. One sad and joyous note was when the Lord called one of the family home.

On Nov. 15, 1974, the first individual contribution for our high school to come through the mail reached our Treasurer. It was from Mrs. Marie Brockelman of Grace Lutheran Church, Seattle. She had carefully, painstakingly, with apparent difficulty, written her check and addressed the envelope.

Mrs. Brockelman's interest in a Lutheran High School in the Pacific Northwest continued and was recently expressed when she began the circulation of a "Jacob's Coat" in Grace congregation to encourage contributions for the high school. The "Coat" is a man's shirt on which members of the congregation sew colorful patches, and under which are placed cash contributions for the High School. Mrs. Brockelman was called to heaven to be with Jesus on Sept. 4, at the age of 84. Her Pastor, Daniel Sabrowsky, reports that the "Jacob's Coat" continues to be patched by members of his congregation - in memory of Mrs. Brockelman and for the Lutheran High School she wanted so much for all of our children in the Pacific

Northwest District.¹³

Mrs. Brockelman and the children of Parkland were certainly examples of giving to the Lord. Another great example of faith motivated giving was and is Bruce Walden. In January he gave 10,000 dollars to help the new school become a reality. Mr. Walden's name will no doubt come up again. But let me say this right now. There may be a person who has given more to Evergreen in time, talents and treasure but I don't know who it is! Thank you Mr. Walden for everything you have done. As Paul said to Timothy, "Good deeds are obvious, and even those that are not cannot be hidden." (1 Timothy 5:25) The Lord knows what you have done for Him and for the saints.

God was providing the money and he provided a place. Tex Morrow the ELS representative presented some information on an old school located in Dupont, Washington. The Dupont building was being offered at \$500 a month rent! It was almost too good to be true.

With all these things happening the 2nd rally was an important event. It was held at Grace, Yakima on August twentieth. Almost 100 people attended the event of fun, fellowship and work. At the special meeting held in connection with the rally the Association members

adopted unanimously the "New Program." This program stated the intention of opening the high school in September 1978. It also authorized a new position called the Coordinator. The Coordinator's position was meant to bring it all together. He was to contact as many WELS/ELS families as possible, work on the curriculum, and report to the Board. He would give information through the newsletter. And he would offer his assistance to the Board for Parish Education (BPE) in coordinating youth activities in the District. The person that was called was the former principal of Parkland Lutheran School Larry O. Joecks. The "New Program" only needed to be approved by the Board for Parish Education. On October 12, 1977 the BPE gave Larry Joecks permission to proceed with his duties while reserving judgment on opening the school in 1978.

As winter continued to hold sway in the Northwest the calendar changed to the year my brother and Evergreen Lutheran High School were born. It was a time of anticipation like the hectic days that lead to Christmas. It was a year of joy as when you have arrived home after a long absence. It was the year the dream came true.

At the turn of the year the Association had 380 families with 1,294 souls. Financially they had \$29,067.27 meeting one of the two-third requirements. The Board of Directors had a change of Chairman. Pastor

Arthur Valerio was replaced by Pastor Daniel L. Sabrowsky. In Sabrowsky's first article in the "Newsletter" (Formerly "News") he gave this tribute to Rev. Valerio.

There is something else which goes without saying, and yet needs to be said. Our Association owes a debt of gratitude to our former chairman, Pastor Arthur Valerio. His leadership and the efforts which he expended for the Association have brought us a long way, and indeed to the point at which we stand today. Our prayers of thanks also ought to be presented to the Lord's throne for the leadership which He provided to us through Pastor Valerio. We also need to pray for the continued blessings of our Gracious Lord upon our former chairman. To you, Pastor Valerio, from the Association you served so well, a hearty thank you, and an enthusiastic WELL DONE!¹⁴

Pastor Daniel Sabrowsky was accompanied by Vice Chairman Rev. Gerald Ditter, Secretary Arnold Goodger and Treasurer George Egerter. These were the officers of the Board when they made their historic suggestion. On March 4, 1978 the Board Directors meeting at Grace, Yakima voted to suggest starting the high school in September. The vote was eleven Yes and four No.¹⁵ Now it was a matter for the Association's annual spring meeting held in Dupont.

This was a big decision facing a very small District. Could we support such a large project? Was it good stewardship especially since many of the churches were still missions on subsidy? Was it God's time?

¹⁴PNLHSA Newsletter 2-1-78

¹⁵Minutes PNLHSA Board of Directors meeting 3-4-78

These were things that were on the minds of committed Christians throughout the District in the spring of 78. And not everyone was united.

Pastor George Frey the President of the District was not in favor of opening the school at this time. He had some very real and good concerns to bring up. For one thing the high school would not just have an effect on a few parents and kids but the work of the whole District. Could a district of @ 3,200 communicant members really support a school? He also pointed out that the missions of the District were receiving around 100,000 dollars in subsidy from the Synod. Would the High School hurt the District's mission offerings which were around \$128,000 at the time? His conclusion was that he didn't feel it was good stewardship to start the school at the time but to grow stronger and larger and then open the school.

President Frey was not alone in that evaluation. The Board for Parish Education under Chairman Rev. John Henning also voiced their concerns. They felt that yes the school had enough money to start with but what about the future? Could the District with 1/2 the congregations on subsidy really support the ever expanding budget of a high school. The other concern was that the high school would hurt the many churches that

were starting their own grade schools.¹⁶ Not only did the churches have the Synod to support but grade schools and now a high school. Is it wise?

Pastor Sabrowsky does a very good job of summing it all up in his article for the Newsletter. (For this full discussion read the March 15, 1978 Newsletter) He began with giving the "plus factors." 1. The financial criteria for opening the school were met. 2. The Dupont facility was there for only \$500 a month and any work done on the building would be subtracted from the rent. 3. The projections said that the school could open with 30 students in the ninth and tenth grade. 4. There was a healthy enthusiasm held by the supporters of the school.¹⁷

Pastor Sabrowsky then covers the other side in a very frank, objective and Christian manner. Only at the end does he express his own personal feelings in I believe a very constructive way.

As your chairman, I have wrestled with the following question. Should I just present the pros and cons of opening in 1978 with little or no editorial comment? Or should I speak out the things that are my own personal feelings in the matter? I decided that as your chairman, I have an obligation to speak my feelings and thus seek to give guidance to you as you make your decision.

I personally feel that we would be foolish not to give serious consideration to the points that the leaders of our District raise. We have elected them to give us guidance and leadership, and they are men who have a handle on the workings of the total program of our synod; and of the impact which any new program might have upon

¹⁶PNLHSA Newsletter 3-15-78

¹⁷PNLHSA Newsletter 3-15-78

already existing programs. There are also indications that the majority of the pastors of our district feel that it would be better for us to wait until our district is larger and stronger before we vote to open our high school. This is also the advice of our District officials. I agree with their advice. My vote was one of those on the board which said "wait." I am not urging you to vote the way I have voted. I am asking you to carefully and prayerfully weigh all of the factors which have been mentioned. Discuss the matter with your family, and with your pastor, take the matter to the Lord in prayer, and then let your vote reflect that which you feel is truly the best thing for the Lord's kingdom at large, and for our district. May God bless your consideration of this matter, and may He lead our association to the decision which is His will. I can assure you also, that if the Lord directs us by our vote April 1, to open our school in September, that I will wholeheartedly support the decision, and do all within my power to bring our high school to a reality, and to continue to help it thrive, and grow, and improve.¹⁸

In the same Newsletter George Egerter the Treasurer presented the majority opinion to open the school. He added a few additional factors to think about. For one thing the ELS had 900 communicants in the area adding to the base of the young school. He also pointed out that at the time the Pacific Northwest District averaged \$40 a communicant in Synodical offerings which was 2nd in the Synod! Compare that to a couple of the Wisconsin Districts that had Lutheran High Schools and gave only twenty-three to twenty-six dollars per communicant. The question could then be raised shouldn't they close their high schools? But Egerter's real thoughts were that this school does fulfill the great commission, will

¹⁸PNLHSA Newsletter 3-15-78

bless our children and can be supported by our membership.¹⁹

So that's where it stood until the Association meeting at the Dupont school. It would be only one meeting instead of three regional meetings.

April 1, 1978 the annual spring meeting commenced with around 140 people in attendance. After some presentations and discussion the motion was made to open the High School for the school year 1978-79. In the words of the minutes:

The motion was then called. Our Chairman then led us in prayer. We asked that the Lord show us His will in the matter.

In the ballot that was then taken, there were 67 YES with 48 NO ballots. This included all absentee votes received by the Secretary at the time of the vote.²⁰

Before the month was out the Dupont school was the place for yet another important event. April 27/28 the doors were opened for the Northwest youth rally and a special meeting of the Board of Directors. Among the many questions the Board faced was what to call the new school. The names that had been suggested were Ebenezer (based on the 75th anniversary of Lutheran High School education in our circles), Cascade, Rainier, Evergold and Evergreen. The children at the rally also contributed by suggesting names for the mascot, school colors and other things. The mascot suggestions were: Nobles, Steelheads, Golden Hawks,

¹⁹PNLHSA Newsletter 3-78

²⁰Minutes of PNLHSA Annual meeting April 1, 1978

Evergreeners, and Eagles. One of the participants Brent Morgan from Yakima was the first applicant to Evergreen Lutheran High School.

Now that Evergreen was going to start it had to be supported. Grace, Seattle was the first to budget for the new school. They set aside \$600 in 1978.²¹ Holy Trinity Kent followed suit some months later by setting aside \$1,200 in their budget.²² Only self supporting congregations were allowed to budget money for Evergreen.

Just to give you an idea of all the sacrificial giving that was going on I will give you just an exemplary case. Mr. Wayne Baxmann and Rev. Richard Wiechmann were called to be the first teachers of Evergreen. Both of these men lived in Wisconsin. That would be quite a cost (@ \$7,000) to move them out to the Northwest! So Bruce Walden donated his truck and rented a forty-five foot trailer. Pastor Daniel Sabrowsky donated his time to ride and help Mr. Walden. It saved the school about \$4,000! Here is how it worked.

On the eastbound trip, our movers carried the household belongings of the family of Mr. John Schoeneck, former principal at Calvary, Bellevue, to their new location at Christ Ev. Lutheran Church in St. Paul, Minnesota. They also transported the belongings of the former Miss Kris Steinke, teacher at Grace, Yakima, to Wisconsin, after her wedding in Yakima. At St. Paul, they loaded furniture of Mrs. Pagel, the new teacher for Calvary, Bellevue, and

²¹PNLHSA Newsletter 2-1-78

²²PNLHSA Newsletter 5-6-78

took it to Wisconsin, to her husband, Robert Pagel, who will be the new principal at Calvary Bellevue. At Milwaukee, the household goods of our principal, Mr. Wayne Baxmann, and most of the belongings of Rev. Richard Wiechmann, our teacher, were loaded into the big trailer. Some of Rev. Wiechmann's things had to be loaded into a small trailer, which he towed behind his car to Tacoma. The Large tractor-trailer arrived in Seattle on July 6 after a safe journey that had passed rather closely two killer tornados in Minnesota! Mr. Walden and Pastor Sabrowsky were unaware of this at the time. Mr. Baxmann and Rev. Wiechmann and their families arrived in Tacoma on July 9, and their household goods were unloaded into their homes on July 10.²³

Mr. Walden and Rev. Sabrowsky were just two of the many who gave their time and talent to the project that was Evergreen. There were people who cleaned, painted, varnished and a whole host of other things the school required. Perhaps it would be good to conclude this section of the history on a description of the Dupont School or first home of Evergreen.

Dupont is a very small town south of Tacoma and north of Olympia. It is in the Steilacoom School District. In 1917 a large public school was built in Dupont. By 1978 the Steilacoom district was interested in finding some renters for the large and unused building (See Appendix 4). The building had a good amount of classroom space, a large room with a stage, a gym and athletic fields. There were three renters. Evergreen, City College or University and of all things a Latter Day Saints (LDS)

congregation! The LDS church was primarily using the stage area for their church. It later became Evergreen's chapel. City College was using several classrooms during the afternoon/evenings. This gave the new school ample room at a reasonable price. It was quite a situation to begin a school with but the Lord blessed Evergreen through it. For the most part the tenants got along quite well. The groups generally made agreements among themselves as far as utilities and maintenance work. After a few years the Mormons ended up with their own church and Evergreen and City University were the only two tenants of the building. That relationship lasted until 1988 when the Steilacoom School District sold the Dupont school to the Weherhaeuser Company forcing both Evergreen and City University to move.²⁴

With a building, with teachers, with supporters, with students, with parents, with the blessing of God, Evergreen Lutheran High School was about to become a reality. The dreams and visions of the past were finally being realized. Wayne Baxmann said it this way on the eve of the school's opening.

September 6, 1978, is an historic day in the Pacific Northwest. After many years of praying and planning, we are ready to open a Lutheran high school in this district. God has clearly shown us that it is His will that we establish Evergreen Lutheran High School. In

²⁴Letter by W. Baxmann 3-13-85

the past months He has opened doors and presented us with opportunities that would astonish even the strongest Christian. Unbelieving observers shake their heads in dismay as they watch this manifestation of God's grace.

God has told us that if we ask, we shall receive; if we seek, we shall find; if we knock it shall be opened. Truly He has upheld His promise.

Thus, the worship service that will open Evergreen this week will not just begin the school year at ELHS, but it will give us all an opportunity to praise and thank God for this wonderful gift. This opening service surely will be a moving experience for the 26 young Christians who make up the first student body of ELHS.

So, Lutheran secondary education is no longer a mere dream in the Pacific Northwest. As Pastor Kahrs stated in his sermon at our installation service, "Evergreen Lutheran High School is now a reality." This is real reason to sing with the psalmist: "Oh, clap your hands all ye people; shout unto God with the voice of triumph.' 'Let everything that has breath praise the Lord; praise ye the Lord.²⁵

1978-1979 The First Year

On September 5/6, 1978 Evergreen was born! Evergreen was created for a purpose-to glorify God by giving his children a Christ centered education. Principal Baxmann reminds the students and us of that very fact.

Dear Students of Evergreen Lutheran High School,

Have you ever really thought about why you attend ELHS? If you wanted a big school atmosphere with lots of students and classes to choose from you would have gone somewhere else. If you wanted a chance to take lots of vocational type courses in which you would have all kinds of tools and equipment to play with you too would have gone somewhere else. If you wanted a first class, top

rated athletic program you surely would have gone to another school. If you wanted a broad, worldly education..., yes, you would have gone somewhere else. So why are you here? Clearly, most of you want something that you cannot get "somewhere else."

God provides us with the reason, He says in His Word that the "Fear of the Lord is the Beginning of Wisdom." God gives us a reason for existing as a school, and He gives you a reason for being here. That's the purpose and motivation that we need.

Praise Him for this opportunity to learn to fear the Lord even as you get your academic education. Pray that He will bless your education here at Lutheran High, and that this will always be our sole purpose for existing as a school.

Let this be the theme of our school and everything that we do here. Let this also be the theme of this our second edition of our school's yearbook. "The fear of the Lord is the Beginning of Wisdom."²⁶

Evergreen began with three teachers committed to teaching the fear of the Lord. Wayne Baxmann was principal, Rev. Richard Wiechmann and Mr. Mark Tacke were teachers.

Mr. Baxmann comes to us from Milwaukee, Wisconsin where he was a member of the faculty of Wisconsin Lutheran High School for 13 years. He taught in the areas of English and Speech. For several years he served as special guidance counsellor, and became Guidance Director in 1974. He holds a BS degree in Secondary education from the Univ. of Wisconsin, Milwaukee; and a M.S. degree in Guidance and Counselling from the same school. He and his wife, Renee, have three children, Dale, Beth, and Amy. He is not new to the Northwest having been stationed at Ft. Lewis for a year.²⁷

Rev. Wiechmann began his ministry in Orlando, Florida where he was called to begin a new mission upon his graduation from the Seminary in Mequon, Wisconsin. He then accepted the call to serve on the faculty of Wisconsin Lutheran High School where he taught in the Religion Dept. and served as guidance counsellor and assisted

²⁶Baxmann, W. 1980 Yearbook

²⁷Installation Service Bulletin Aug 13, 1978

with coaching. He holds a B.A. Degree from Northwestern College; A B.D. Degree from Wisconsin Lutheran Seminary; and a MA Degree from Marquette University in the area of history. He and his wife, Jean have two children; Renee, and Rae Ann.²⁸

Mr. Tacke has attended Northwestern and DMLC for a total of four years and, thus, has only one semester remaining to gain his teaching degree. Since he has pitched for a number of baseball teams and likes all sports, he will assist in our physical education department. He loves the outdoors and is anxious to explore the state of Washington. Since he collects rocks, leaves and plants, he seems to be a natural for our science department.²⁹

Teacher's were only part of the blessing. God blessed Evergreen with students who were willing to give the new school a try. Initially twenty-six students were enrolled, by the end of the year the number had jumped to thirty-two. There were many new things in that first year but I want to let the students speak about their activities and about their school.

Glee Club

by Ellen McCullough, Port Orchard Wa.

Here at Evergreen we have what we call "Glee Club." It consists of a dozen of us students who form a special little choir. We've gone to Calvary Lutheran in Bellevue and Grace Lutheran in Seattle to sing in their church services. In February, we will be singing in Renton and Kent. During Lent, we plan to visit Bethany in Port Orchard and Faith and Parkland congregations in Tacoma. We've been working on some new music and we'd like to be able to sing in all of the Lutheran churches in our immediate area by the end of the school year. Don't hesitate to invite us.

Honor Roll

by Linda Albert, Federal Way Wa.

I believe it is beneficial to have honor rolls because they give

²⁸Installation Service Bulletin Aug 13, 1978

²⁹PNLHSA Newsletter 9-1-78

students an incentive to achieve something more than they are at present. An added bonus are the Mariner Honor Student tickets. Students earning a 3.2 grade point average are eligible for two free tickets to three Mariner home games. The honor roll serves to encourage them to continue their high level of performance and it rewards them.

At evergreen Lutheran High School we have two honor rolls. "Honors", whose members have a 3.5 G.P.A. or better and "High Honors", which requires a 4.0 G.P.A.. The members of "Honors" are Tammy Dunn, Randy Ostrom, Mike Sabrowsky and Craig Wentzel. Linda Albert and Renee Faubion made "High Honors."

Basketball

by Jim Perry, Camus Wa.

Basketball is in full swing at Evergreen. Under the coaching of Tom Dobberstein, we have learned a lot about the game.

So far we have posted an 0-2 record. We suffered losses to Charles Wright and Seattle Lutheran. But in our second game, we showed lots of improvement. We went into the locker room at half time with something we're not used to, a lead, 20-17. But we ended up losing the game largely because our star Mark Teske, was taken out of the game with leg cramps.

We play again January 30th against Concordia. We could use a few more rooters at our games, so you're welcome to come. Until basketball began, Evergreen wasn't used to losing in sports, so I think we'll get it together against Concordia and get back on the winning track.

We began our season with a pickup game against young men from our area churches. Even Mr. Baxmann played against us. They had all the height on us but we defeated them because they had never played together as a unit before. We are always willing to play, so if you can get a team together, just notify our principal and he'll set up a date.

Our team includes frosh Aaron Gibbs, Ren Harner and Shon Smith. The sophomores on the team are Mike Knowles, Mike Sabrowsky, Jim Perry, Mark Teske, Randy Ostrom, Jerry Lafrati, Rod Hominda and John Buettner.

Yearbook

by Tammy Dunn, Bellevue Wa.

We, the students of Evergreen Lutheran High School, have decided to have an "Annual" this year. Mr. Tacke and a few of us girls

met with a lady who put together Concordia Lutheran's yearbook. She showed us how to type up the pages to correspond with the pictures and gave us many pointers on how to put together a successful yearbook.

We have already started working on our book and everyone is having fun looking at and sorting our candid shots. Even though it will take much time and effort, we think our book will be a fun project.

If you know of anyone with a business who would be interested in advertising in our yearbook, please drop us a line at the high school as soon as possible.

Student Council by Jon Buettner, Tacoma Wa.

This year the student council at ELHS consists of Ellen McCullough, Linda Quick and myself. So far this year we have met with Mr. Baxmann several times; we've decided on school colors and mascot, and have decided to purchase jerseys and hats to promote school spirit. Our student body is very enthusiastic and we are proud to serve our class as their representatives.³⁰

In that very first year the students began to praise God with their voices. That tradition of singing and being ambassadors of Christ to our congregations has continued to this day. Even in the first year the choir sang in almost every congregation in the Seattle/Tacoma area including trips to Vancouver and Yakima WA!³¹

ELHS started out with several opportunities to play sports and be representatives of Christ to the community at large. In the fall the boys participated under Mr. Tacke in an undefeated flag football season. In the winter Tom Dobberstein coached boys basketball and Rev. Wiechmann the

³⁰PNLHSA Newsletter 2-79

³¹Principal's report 4-6-79

girls. Cheerleading was also available. In the spring for those who liked to run there was cross-country under W. Baxmann.

One blessing of an area Lutheran high school is how it draws people together. Evergreen was such a blessing. On March 10, 1979 the first grade school basketball tournament was held. The first competitors were Parkland, Faith-Tacoma, Salem-Edmonds and Lakewood. This brought families, parents and congregations together to enjoy each other. Faith enjoyed it the most since they were the very first champions.³²

The school also enjoyed the fellowship of two synods. As of July 14, 1978 ELS men could be members of the Board of Directors but only in an advisory role.³³ At the December 8, meeting in Ellensburg the Board made the recommendation that ELS members become eligible for membership on the Board of Directors.³⁴ This was approved at the annual meeting on April 21, 1979.³⁵ Now Evergreen was truly a high school of both the Wisconsin and Evangelical Lutheran Synods. This has been such a blessing to Evergreen and the Christians in the Northwest as a whole. First of all we realize what a blessing it is to have fellowship, to be united with brothers and sisters in the faith. It also helps to be united and different.

³²Board of Directors 2-2-79, PNLHSA Newsletter 4-79

³³Board of Directors 7-14-78

³⁴Board of Directors 12-8-78

³⁵PNLHSA Annual Meeting 4-21-79

We can get the best of both synods. I think of the choirs who have been given the opportunity to praise God in ELS and WELS congregations. I think of the times when large services were held at Evergreen and members were together as the body of Christ. Evergreen has also prepared students who have gone on to serve their Lord as members in both synods. It is also proper that the school be fully WELS and ELS because as the Board of Directors said, "Members of the ELS have rendered invaluable service to our High School."³⁶ I think it is safe to say that without the support of the ELS members, Evergreen would not have started when it did and wouldn't be the Evergreen that it is today.

But what did Evergreen mean to those early students? Listen to these two evaluations.

ELHS's first year of operation is almost done, and I have to say I'm sad. Summer will be a break from homework, that's for sure, but I know I'm really going to miss all of my friends. I don't see them much in the evenings because I live 44 miles from the school, but I at least see them every day. To get to school I leave home at 6:10 and I return home at 5 p.m. This makes for a long day but I know it's worth it. Evergreen is really terrific! I've never gone to parochial school before (public only) and I'll admit, in September I wasn't 100% optimistic but I'm very glad I came. ELHS isn't anything like I thought it would be--it's better!

Friends made at Evergreen are special. The school is small, so you can't have 50-60 friends, but the 30 you do have are very close. We're like a huge family. We gained a few students during the year, but by now, they're part of the bunch too.

³⁶Board of Directors 12-8-78

The teachers here are the best! They always explain things we don't understand, and even though they are constantly busy, if you have a problem, they'll make time for you. Here at Evergreen I never have to sift what is told me. At my old school I did.

Last year for something to do, I kept a record of how many class hours were wasted. This year I need more hours to get all my work done! But I can't complain. I think I've learned more this year than I have in the last two put together.

I'm very confident that ELHS is a blessing from God for His people in this area. I'm thankful for this and also for all the people who spend their time and talents to support ELHS. May God continue to bless them and their efforts. By Ellen McCullough, Port Orchard, Washington³⁷

My first year at Evergreen has been a lot of fun. You can really get to know all the kids in school because you're with them every day. Last year I went to Martin Luther Academy. You learned to make friends in classes and at the dorm, but here you know everyone. The atmosphere is much more informal than school last year. Around here you're good friends with the teachers as well as students.

There is always something to do around school. All the students help with the Newsletter so you can find out what's happening at Evergreen. We also help the teachers when they need to get something done.

The sports activities were a lot of fun this year. The guys had flag-football during the fall, basketball during the winter and are playing lots of softball this spring. Next year we are having soccer instead of flag-football and will have a baseball team. The girls usually watched the football and basketball games and cheered for their team.

It is really nice to have a Lutheran high school in this area. It's so much nicer to be able to go home to your mom and dad more than twice a year. Last year was good in some ways because I learned how much my mom and dad meant to me. But now I can fully appreciate my mom and dad.

It's been fun being a part of the growing of Evergreen Lutheran High School. I feel lucky to have had the privilege of completing my sophomore year in a new school. It is through God's blessing that this school started and I was able to come here. We are all truly

grateful to the people of this district for supporting our school.
Thank you! By Tammy Dunn, Bellevue Washington³⁸

1979-1988 Dupont Years

Any parent can tell you that raising a child is hard work. There are moments of frustration, times of tears and episodes of despair. Add to that hours of worry, years of labor and piles of money and you have parenting. But it's all worth it when the baby laughs, when she is confirmed, when he graduates, when they get married. There is no greater potential for joy or sorrow than our children. There is no greater work than to raise a child in the fear and admonition of the Lord.

That is why the Christians of the Northwest decided to give birth to Evergreen Lutheran High School. They wanted their children to have Jesus in every class and every subject. They wanted Jesus to be in practice and on the field. They wanted Jesus in the dorms and in the canteen. They wanted Jesus to be praised by the kids in choir and those in woodshop. Evergreen was born with that goal in mind.

But raising children is hard and childhood is hard. Evergreen's childhood was no different. In this section of the history I am going to look at some of the bright spots in Evergreen's childhood years. We will
38PNLHSA Newsletter 6-79

also see some of the problems and the work it took to keep it together. More than that I hope you see our faithful Lord behind it all, working out all things to our good.

One of the real strengths of ELHS has been its sports programs. I'm not saying our teams always dominated or always had winning records. That doesn't make a good sports program. A good sports program is Christ centered. It is coaches encouraging and teaching students to do their best to glorify God win or lose. It is a program that allows every student to participate in some way. Otherwise what good is physical education and all that it teaches if you are only teaching an elite few? Because of the size of Evergreen everyone was able to contribute. Sports was also a blessing because of the faculty. The faculty went above and beyond. They not only taught classes they spent extra time teaching on the athletic field.

In the first year ELHS had flag football, basketball and cross country for the guys. The girls could play basketball or be cheerleaders. In the second year soccer replaced flag football and the girls gained softball. Softball lasted until 1981 and was replaced by a co-ed track team. In 1981 girls volleyball was added in the fall. In 1984 a golf team was born for those who really didn't like to run! These were the teams throughout the

Dupont years.

Although the agony of defeat was not unheard of, there were some real high points in those early years. One of those was when the girl's volleyball team took 2nd in the SeaTac league. A member of that team was specially honored.

Senior Dawn Nollmeyer was named to the 1983 KING 5 Sports "All Around Volleyball Team." She was one of only six girls named to the team from all the high schools in King and Pierce counties. Students were chosen because of their outstanding contributions to their school and their community, and because of their exceptional performance in the classroom and on the volleyball court. Dawn was honored at a brunch held at the Seattle Sheraton. Later that day she and her parents were guests of KING 5 at the Seattle Seahawks game against the New England Patriots. Dawn and the other five members of the All Around Volleyball Team were introduced to the Kingdome crowd from the middle of the football field. This is a real honor for Dawn. We congratulate her.³⁹

Another high point was the 1985 soccer trip to WISCO. It was a great opportunity for the guys to play against other kids who actually believed the same things they did. Apparently some of the faculty were a little "jealous" of the coaches and their trip to the heartland. This statement was found in the faculty minutes. "When Mike and Nate are galavanting around in Milwaukee the faculty with the help of Mary Gillespie will cover their classes."⁴⁰ As a student I always suspected

³⁹PNLHSA Newsletter 1-84??

⁴⁰Faculty Minutes 9-18-85

that the teachers had a sense of humor.

In 1987 the girls basketball team was honored by the WIAA for having a team grade point average of 3.71. That really shows the hard work of the girls both on and off the court.

Perhaps the greatest high point in the sports arena happened on February 11, 1986. That was the day the guys Varsity basketball team played Seattle Lutheran in the Coliseum before the Sonics game. Seattle Lutheran was a considerably larger school and we had never beat our heterodox brothers in basketball. They did that night! When the buzzer sounded at the Coliseum the score read Eagles 44, Saints 43! The members of that team: Matt, Pietrusiewicz, Mark Steffen, Steve Hinz, Jeff Snow, Deran Schneider, Rob Knapp, Phil Hinz, Lance Liesmann, manager Alan Murvine and Coach Mike Oesch. This game could probably match any in the school's history for emotion, suspense and determination.

Choir was another shining spot for ELHS. Choir gave students a chance to represent their Lord and Evergreen at the churches. Choir gave the kids a chance to serve the churches with God's word in song. Choir gave students a foretaste of heaven. I'm not sure we're going to play basketball in heaven but I know we will sing God's praises. For these reasons and more choir has always been a part of ELHS.

Right from the beginning the effort was made to visit not just the local churches but those further away. As a result the choir often toured in Eastern Washington and made trips to Portland. The pattern that developed had the choir do Advent and Lenten services in the Western Washington churches. Then a small tour would often go to Eastern Washington. This touring had the added benefit of keeping the distant churches involved and informed. It also gave fellowship and encouragement to Christians separated from each other by many miles.

Going out for choir also meant you got to travel beyond the Northwest. In 1983 the choir began to go to the annual Lutheran high school "Choral Festival." One adventuresome trip was in 1984 when the choir went by bus to Manitowoc, WI. Equally exciting was in 1985 as airline tickets fell the choir was allowed to go to the Choral Festival in Arizona. Before the festival they however made a stop at Disneyland where they were given free admission if they performed a song.

Another way Evergreen praised God in song was in group choirs. The Christmas concert of 1980 is a good example. On December fourteenth three choirs joined their voices in praise to their Savior King. The Evergreen choir of twenty-six under Rev. Wiechmann was joined by choir made up of the grade school students directed by Bruce Noah, and the

Puget Sound Lutheran Chorale a group of WELS and ELS singers under the guidance of Rev. John Henning.⁴¹ What a neat concert with God's children of all ages praising him.

Sports and Choir are great blessings but finally it comes back to students. Without students there is no Evergreen. Praise the Lord that he moved the hearts of so many young people and parents so that they became a part of Evergreen. In the 1978-79 school year Evergreen had thirty-two students in two grades. In 1980 with the addition of the Junior class the enrollment shot up to sixty students!⁴² During that year there were twenty one to twenty-three boys staying in the dorm. This was a single story apartment building that was located in Dupont. The very next year the guys dorm became what is commonly known as the girls dorm. On August 25, 1980 the mobile units arrived.⁴³ These would function as the boy's dorm throughout the Dupont years.

In the fall of 1980 ELHS opened it's doors as a full four year high school with a girls and guys dorm. The Lord was providing! In the fall of the 1983-84 school year Evergreen had grown to seventy-one students.⁴⁴

Evergreen saw it's largest student body of the first ten years in 1986.

⁴¹PNLHSA Newsletter 11-79

⁴²1980 Yearbook

⁴³ELHS Faculty Notes 8-25-1980

⁴⁴Update 10-83

That year there were eighty-three students enrolled.⁴⁵ There were nineteen seniors, twenty juniors, eighteen sophomores and the biggest class of the first ten years the freshmen with twenty-six.⁴⁶ After this the student body began to shrink. In 1987 there were sixty-two students⁴⁷ and in 1988 only fifty-eight.⁴⁸ The decline continued into the Kent years and only in 1993 and really in 1994 did the student body reach the enrollment of 1986.

If numbers were the measure of success I think many would conclude that Evergreen was a failure. That of course is not the standard we use to measure our schools. Our schools answer to the Lord. Success is faculty remaining faithful in their service and students applying themselves faithfully to what God has placed before them. That makes Evergreen a very "successful" school indeed.

I would like to be able to say that Evergreen was a perfect success. I would love to tell you that the faculty and students were perfect people. I can't. During the first ten years the sinful nature made itself known. There were students who got involved with drugs. Many disobeyed the laws of the land and school by using and abusing alcohol. There was

⁴⁵Update 9-85

⁴⁶1986 Yearbook

⁴⁷1987 Yearbook

⁴⁸1988 Yearbook

destruction of property both school and city. There were unkind words, sinful attitudes and disrespect. Students did not always keep their hearts, words and bodies pure. You name it and it was probably done, if not at Evergreen then in one of the area Lutheran high schools or in one of the prep schools. No Evergreen was and is not perfect. Did you expect it to be?

Principal Baxmann wisely reminds us of a very important fact that we tend to forget. "If all our teenagers were angels, they could all go to public schools, and we would not have to exist."⁴⁹ The great strength of our schools and churches is not that they are full of perfect people. The great strength is that they are centered on Christ crucified. Evergreen is a Christian school even when a student, teacher or parent gives in to his sinful nature and falls. It is a Christian school because law and gospel are faithfully used. Sin is not condoned but exposed and rebuked by the law. Sin and guilt are done away with by the comforting words of the gospel. Because Evergreen is not perfect the gospel predominates. The gospel is there to announce forgiveness, life and salvation. The gospel also empowers the Evergreen family to live lives of thankfulness and obedience to God their Savior. Evergreen is not perfect or sinless but it has the

⁴⁹Principal's Report to Board of Directors 10-5-79

answer to sin. Jesus Christ the perfect Son of God who has paid for the sins of the world is that answer.

Wayne Baxmann was certainly a blessing from the Lord. God gave him to Evergreen as it's principal for six years. In 1984 God had other plans for him and called him to serve in the Midwest. However his days of being an ALHS principal were not over. Presently he is the principal of Kettle Moraine Lutheran High School in Wisconsin.

It must have been a hard thing for the believers and the schools of the prophets to know that God was taking Elijah from them. What would they do now? Would the next person be as good? It just won't be the same. Yet when God took Elijah he gave Elisha. In the same way when God called Baxmann to another field of service he faithfully provided Evergreen with Werner Lemke. This history from the December issue of the Update let's you know what a faithful servant God was giving Evergreen.

He says his professional life has been parceled out in "sevens": seven years a principal in Minnesota, seven years a teacher in Arizona, seven more as a principal in Yakima. And then the move to Dupont!

Mr. Werner Lemke, who counts the sevens coincidence and lets God decide the moves, is pleased to be the man at the big desk behind the door marked "Principal's Office." Son of a Minnesota parsonage, Mr. Lemke was born in Watertown, South Dakota, and got his grade school education at Butterfield and at Immanuel Lutheran School

near Hutchinson, both in Minnesota. Upon graduation from the former Martin Luther Academy, New Ulm, he spent two years at Northwestern College, Watertown, Wis. Then it was back to New Ulm and four years at Dr. Martin Luther College. A certain Judy Meyer was a member of his 1963 graduating class.

During youthful summers in Minnesota student Lemke drove a ready-mix concrete truck. One summer he fought forest fires with the forest service of the U.S. Dept. of Agriculture in Idaho. "That was the hottest, dirtiest job I ever had in my life," he said, and told how he went without sleep for 36 hours fighting it.

In St. Paul Park, Minn., Mr. Lemke taught upper elementary grades. At the WELS Apache mission, White River, Arizona, he taught high school religion and math and coached baseball, basketball and football. At Grace Luth. School, Yakima, he was principal and taught grades 7-9.

Classmate Judy Meyer, who taught at a Lutheran school in Geneva, Neb., became helpmate Mrs. Lemke at their wedding in 1964. Today son Peter is an Evergreen senior (Now 1998 a teacher in WELS), Kristi is an Eagle freshman (Now graduated from DMLC and married to WELS pastor), and Heidi is in 5th grade at Lakewood Luth. School, Tacoma (Now a missionary/teacher of ELS).

Last August Mr. Lemke received his Master in Education degree at Central Washington University, Ellensburg. Mrs. Lemke is working towards the same degree from the same institution.

Mr. Werner Lemke was formally installed as Evergreen's new principal by WELS District President George Frey at the Reformation Festival service held in Evergreen's gym Sunday, October 28.⁵⁰

Mr. Lemke had a strong grasp of what Evergreen was here for. In 1986 he summed it up in these few words. "Life and death is where Evergreen Lutheran High School is at. What do we need to teach so that our students learn to live in this world and are ready for the most glorious "day" in their life? That is the question the Board and faculty always

⁵⁰Update 12-84

needs to keep before themselves."⁵¹ This strong focus was sorely needed in the face of Evergreen's problems.

The major problem Evergreen faced was money. Before Mr. Lemke was principal ELHS had trouble raising the necessary funds to operate in the black. After the 1982-83 school year ELHS was in the red by 18,000 dollars.⁵² That year Rev. Wiechmann (Teacher at ELHS) sent a letter to the Board of Directors giving his thoughts on the problem. First he says, "Twice during the summer we were unable to receive or cash our paychecks on time."⁵³ There was a very real problem. He makes basically five other major points. One was that since the 1981-82 budget a series of events have all pushed the budget to the negative side. The second problem he saw was that Evergreen had no major fund drive going. He also felt that there was a lack of communication between Evergreen/Board and the pastors' and teachers' conferences. Without clear communication how could the churches help? Along those lines it was his opinion that the Update was not a very efficient fund raiser and couldn't effectively be used as such. Finally he suggested that perhaps the board should look for Christian men with more experience in financial affairs and utilize

⁵¹Principal's Report 10-3-86

⁵²Update 10-83

⁵³Wiechmann's letter to Board of Directors

them.⁵⁴ It should be noted that the letter was very evangelical and written not to criticize but to raise questions and start discussion.

Rev. Wiechmann had a right to be concerned. When January 1984 came around the accounts payable had the large number of \$21,004.99. The amount in the bank was only \$2,825.57.⁵⁵ During the 1984-85 school year the school needed \$15,000 a month in contributions. Only in December did it reach that amount all the other months fell short.⁵⁶ As of June 30, 1987 the school was around \$35,000 dollars behind. The income for that year was \$293,707.99 but the expenses came to \$313,925.75!⁵⁷ Once debt starts it is hard to get yourself out. As a result the monthly income needed in the 1987-88 school year jumped to \$27,000 per month.⁵⁸

These were some tough times. The list of creditors in 1988 was long. ELHS owed everyone from Apple Computer to the Wisconsin Synod Pension fund.⁵⁹ This put the teachers in an awkward spot. Not only did they get checks late but then they had to explain to companies why they couldn't pay the bill. On top of that they had to assure and continue to give the students a stable high school environment. It isn't easy to be

⁵⁴Wiechmann's letter to Board of Directors

⁵⁵Update 3-84

⁵⁶Update 11-85

⁵⁷ELHS Income Statement 1986-87

⁵⁸Financial Information 1987-88

⁵⁹Creditor List 1987-88

optimistic in class when you're not sure you're going get paid this month or when you're worried about the school's future.

I have often told this story to my friends from the synodical schools. It was winter in my last year of high school 1987-88. My classmates and I are huddled together in the middle of the room, shoulder to shoulder. We all have our winter coats on and one girl even has a blanket. The teacher isn't separating us. He is too busy getting more old books from the library to throw on our fire. If he returns in time and the fire in the burn barrel doesn't go out we will survive one more class day. What were we thinking as we battled the cold inside the Dupont building? We were all dreaming about the heated pool at Martin Luther Preparatory School but alas there was a great chasm between them and us. Now some of this story is perhaps exaggeration but there is truth in it. In fact I finally have documentation to prove it. In one document it says, "We have been turning it (thermostat) down to the minimum (50-55) after about 10:00 or 10:30 and turning it back up to 62 at 5 p.m. for City University's night classes."⁶⁰ Mr. Lemke gives it more feeling in his Principal's report. "We have not turned on the boiler and at times it has gotten a wee bit cold."⁶¹

Finances were a constant problem at Evergreen Lutheran High School

⁶⁰Conversation with Creditors March, 1988

⁶¹Principal's Report 10-3-86

and it would have been easy to have been consumed by such problems. It would have been easy to succumb to worry. It wouldn't take much to lose sight of the purpose and more importantly the Lord who provides. That is why I appreciate these words of Mr. Lemke in 1987.

I recently read that Christianity in the United States is dying on the vine. That's a scary thought. When a person looks around it seems that Christianity and the moral standards which give evidence to Christian beliefs are indeed "dying on the vine."

My experience with plants which were "dying on the vine" has not been good. Most often I lost the plant before I could bring about a remedy. This problem has, over the years, cost me considerable money.

A dead plant is one thing but a dead soul is another matter. Plants can be replaced but lost souls are gone forever.

What can we do to save the souls of those who are "dying on the vine"? God has told us: "Preach the Gospel." That Gospel is taught each and every day at ELHS. God has also promised that where the Gospel is taught there will be saved souls. It is then our duty as workers in God's vineyard to plant His seed, cultivate His crops, prune His plants and He will bring forth the yield.

Let us then each pledge ourselves to greater zeal in doing the work to which God has now called us whether that be faculty or Board members. Let us rest assured that God will bless the work done during this the 10th anniversary year of ELHS.⁶²

God did bless the work and did sustain Evergreen in those tough times. His word is true. "The lions may grow weak and hungry, but those who seek the Lord lack no good thing." Psalm 34:10 There were so many blessings the Lord gave to Evergreen. For every one I mention I am confident there are two others I don't know about. Still it is fitting that

⁶²Principal's Report 9-11-87

the saints and their works of faith are mentioned to the glory of God the Father. That is what the Update does with it's question, Did You Know?

DID YOU KNOW ? ? ?

-that our students and faculty are voluntarily doing all the janitorial work in our 20,000 square foot building?
-that Mrs. Marjorie Mankin is a highly qualified art teacher who voluntarily gives her time to train our 26 "future artists" at Evergreen?
-that our teachers have voluntarily been providing the transportation needed to get 50% of our student body to and from school each day?
-that the word "voluntary" appears many times on this page and is a major reason why a small district like ours has been able to open a high school.⁶³

People serving the Lord not for money or fame but out of love for Christ. This is the Christian church in action. In December of 1978 Joan Eskew is mentioned as a good example of that volunteer spirit. She was a mother of six and yet still volunteered 2 mornings a week to do office work.⁶⁴

The faculty also went above and beyond. In 1980 the weekend meals on Friday, breakfast on Saturday and Sunday were prepared by the tutor. The rest of the faculty on a rotating basis would prepare the other meals.⁶⁵ I bet DMLC and NWC didn't prepare them for that!

Feeding the students was not an easy or cheap thing. Yet again the

⁶³News 11-78

⁶⁴News 12-78

⁶⁵Faculty Minutes 10-80

Lord provided by moving the hearts of his people. "Food bills have been reduced to \$500.00 a month rather than \$1,500.00 because of the generous contributions of food stuffs by our people in the Pacific Northwest. Among the many items were: 2 pigs, 1 steer, and a part of a steer. Our heartfelt "thanks" to all who gave to ELHS!"⁶⁶

One thing the Lord taught through the hard times was good stewardship. The faculty had to make the most of what was available. We saw that with the heat and janitorial work. In 1987 when the janitor was gone for a time the faculty divided all the work between them and got it done.⁶⁷ One positive aspect of this was that students who needed some law to help curb the sinful nature always had something fun to work on.

Office costs were also reduced. Something as simple as long distance, something we often take for granted was reduced. This note in the minutes shows how much the faculty was doing to reduce costs. "Phone calls: Limit long-distance phone calls to zilch!!! We haven't been spending our budget--we're 10,000 dollars a month short. Therefore do the job with a letter!!!"⁶⁸

Difficult times give the saints a chance to shine. I want to include a

⁶⁶Update 1-94

⁶⁷Faculty Meeting 10-6-87

⁶⁸Faculty Minutes 11-10-88

statement about the Juergens written in connection with what was owed to the various creditors.

The ONE bright spot in all the calls. Mrs. Juergens said the \$145.00 payment was fine--she understands our situation. I told her that I had tried to keep us current (last year we didn't pay them except in September), but we just don't get in enough money. (She has always paid her tuition in full on time.) She said that we didn't have to pay her anything for a while if it would help, but I said that it would only delay the inevitable. (Last year they wrote off over \$2,700.00 but since Mr. Juergens died, we can't expect her to do that--they have bills to pay also.)

It appears that if we really get in trouble, we could go back to her and reduce the amount set up to pay her, but I would rather see us work on reducing our \$800+ balance owing now; we will owe another \$300-400 in a few days for February's milk bill.⁶⁹

I went to school with five of the Juergens kids and have nothing but respect for them. One really great thing is that Valerie Juergens is now teaching at ELHS and she even has family still at the school! These are the reasons Evergreen is here!

Evergreen Lutheran High School was worth the time and struggle. It was worth the long hours, the prayers and the money. It was a special school with a special mission. I pray that these personal thoughts of Mr. Lemke will be your thoughts about Evergreen.

My Personal Thought About Evergreen:

EVERGREEN IS SPECIAL: Not for its buildings - they are old,
tattered, stained here and there
Not for its campus - its crowded, it's noisy

⁶⁹Conversations with Creditors March, 1988

Not for its place in the district - it's far
from many homes

IT IS SPECIAL: Because of its students commitment to
their Lord, their work
Because of the student's parents who
sacrifice for them and the school
Because of the Lord's gifts of love by and
through the school to us its supporters
Because of the students' spirit - "We ain't
got much, BUT we got all we need"
Because it is God's gift to us here in the
PNW
Because it is our responsibility to keep it
going
Because through it a future generation is
being trained to take over the work we
today are doing and which must
continue always!⁷⁰

My Thoughts on Evergreen.

This is the Evergreen that I attended. I was part of the last class of the first ten years. Evergreen was the school that took me from childhood to adulthood. It was the place that the Lord used to strengthen my character and refine me. It was the place where I made more mistakes than I care to remember. Evergreen introduced me to a broader world and encouraged me to continue looking forward to the world to come. The friends I gained there are still my dear friends. The family of God associated with ELHS is the one I still consider my family. Evergreen even after attending Wisconsin Lutheran Seminary is still my favorite school.

One reason I think of ELHS so highly is the teachers God gave me. Miss Barb Jacobson was one of the most respected teachers we had. She was such a great example because of her great organization, science knowledge and Christian heart. Mr. Tom Schwartz also comes to mind. I can't think of a more evangelical teacher, coach or friend. His soft spoken manner and his genuine love for God's people made a strong impression on me. Pastor Stuebs I appreciate now more than I did then. When I look back on all the grief I gave him I am amazed at how he put up with it and me.

And there were so many Christians involved in Evergreen. It was such a blessing to meet and be blessed by all the different pastors. There

were so many good Christian parents that I got to know because of my friends. The Gabert family is such a family. I remember my first year at Northwestern College. The Gaberts had taken a trip back to the Midwest and since they were close decided to stop by and say hi. I don't think they had any idea what an encouragement that was to me in my life at that time. The Sundbys who were there for me the day my dad died. The Sauers whose door is always open for me. The Pietrusciewiczs, Juergens, Kettners, Weisers and many more were all blessings to me. I love Jesus not only because he is going to take me to be with him in heaven. I also love him because he is going to bring the Evergreen family and the entire family of believers together around his throne.

This wouldn't be complete for me without talking about Mr. Lemke. Principal Jon Schoeneck wrote, "Today I introduce Mr. Lemke as our "master teacher." He loves to wrap God's Word into each lesson. Seniors often tell me he is the best teacher they've had. (Another personal note: When I was in seventh grade, Werner Lemke was in his last year of college, and he was my teacher when he student-taught in my elementary school classroom.)"⁷¹ Mr. Lemke is a master teacher. And like Mr. Schoeneck I also had Mr. Lemke in gradeschool. He taught me more religion

⁷¹Update-Winter 1998

than anyone except my father. Of all the people in my life I respect Mr. Lemke more than anyone now living. He has been such a tremendous blessing to Evergreen in his years as board member, principal and teacher. May God bless him as he leaves Evergreen to teach and proclaim Jesus in Malawi.

May God's kingdom continue to come at Evergreen Lutheran High School.

Bibliography

A Lutheran High School For Our District. Prepared by the District Board
For Parish Education to the Pacific Northwest District of the WELS
Presented to the District in June 1973

Walden, Bruce. "Living Proof" (Short history of ELHS prepared in the 10th
anniversary year 1988.

5-74

Revised
See Notes or
original

PREAMBLE:

Mindful of Christ's command to teach all nations, and aware that the Lutheran High School is an effective means of keeping our adolescent youth under the influence of the Gospel, we do hereby adopt the following CONSTITUTION:

ARTICLE I Name

The name of this organization shall be THE PACIFIC NORTHWEST LUTHERAN HIGH SCHOOL ASSOCIATION.

ARTICLE II Purpose

The purpose of this Association, a non-profit corporation organized under the laws of the State of Washington, shall be to establish, conduct, control, manage, and maintain one or more high schools in the Pacific Northwest District of the Wisconsin Evangelical Lutheran Synod and to promote the cause and extend the scope of Christian Education in keeping with the aim of this Association:

ARTICLE III Aim

It shall be the aim of this Association to offer Christian Education on the High School level in accordance with the confessional standards of the Evangelical Lutheran Church both in teaching and in practice. To that end, this Association accepts the canonical books of the Old and New Testaments as the divinely inspired and inerrant Word of God, and submits to this as the only infallible authority in matters of doctrine, faith, and life, and adheres to the confessions of the Evangelical Lutheran Church embodied in the Book of Concord of 1580, because they are a correct presentation and exposition of the pure doctrine of the Word of God. This article shall be and remain unalterable and irrevocable.

ARTICLE IV Membership

Supporting membership in this Association will be opened to all interested members of congregations in the Pacific Northwest District of the Wisconsin Evangelical Lutheran Synods and sister Synods in fellowship with the WELS. A person may become a supporting member by filling out a membership card and submitting it to the Board of Directors.

Voting membership in the Association shall consist of all male members who are classified as voting members in their home congregations, and who have signed a membership card.

ARTICLE V Amendments

This Constitution may be amended by a two-thirds majority of votes cast, provided that a written notice of the amendment be supplied to the members of the Association sixty (60) days prior to a meeting in which the proposed amendment is to be voted upon. Written ballots, validated by the Secretary, will be accepted prior to the scheduled meeting.

BY-LAWS

ARTICLE I Board of Directors

Section 1. Members of the Board.

The Board of Directors shall consist of 15 men from the Wisconsin Evangelical Lutheran Synod who are members of this Association. These men shall come from the three (3) major areas of our District - Oregon and Idaho, western Washington and Alaska, and central and eastern Washington. Each area shall send five (5) men, including a minimum of one (1) layman, one (1) teacher where-ever possible and one (1) pastor.

Section 2. Representatives of the Board.

Each of the three (3) areas shall be responsible for electing their representatives on the Board of Directors. This shall be done in the Fall meeting.

Section 3. Terms of Office on the Board.

Terms of office on the Board will be five (5) years, commencing each January. A member of the Board shall not succeed himself after serving a five (5) year term. For the initial Board of Directors, each area shall designate the length of terms for the men chosen, (one 1 year term, one 2 year term, one 3 year term, one 4 year term, and one 5 year term.) Newly elected members of the Board shall begin their term of office in the January meeting following their election.

Section 4. Officers of the Board.

The Board of Directors shall elect its own officers at the first Quarterly meeting of each year. The officers of the Board of Directors shall also be the officers of the Association. They shall be:

Chairman Vice-Chairman Secretary Treasurer

Section 5. Vacancy on the Board.

Should any vacancy occur on the Board of Directors, each area shall be responsible for filling the vacancy of its area. If the member of the Board was an officer, the Board of Directors shall elect a replacement at their next meeting.

Section 6. Duties of the Board.

The duties of the Board of Directors shall be:

- a. to supervise the activities and execute the decisions of the Association.
- b. at the direction of the Association, to acquire, sell, transfer, convey, mortgage and pledge all real estate and personal property of the Association.
- c. to accept and receive, or reject, grants, gifts and bequests.
- d. to arrange for meeting the financial needs of the Association and administer its funds.
- e. to appoint such committees as it may deem necessary for the best interests of the Association and the school(s).
- f. to call and employ, and dismiss if necessary, personnel of the school(s).
- g. to prepare an agenda for each meeting of the Association.
- h. to approve and supervise any and all activities or organizations relevant to the high school(s).

Section 7. Powers of the Board.

The Board shall be empowered to conduct, manage and administer the affairs of the Association, to hold title to all the money and property, real, personal and mixed, and to all legacies and bequests that shall be given, granted, devised or bequeathed to or be purchased by this Association.

and shall use, manage and conduct the same under the direction of and for the use and benefit of this Association to the extent and under such limitations as may from time to time be prescribed by the Association.

Section 8. Limitations of the Board.

This Association reserves to itself and to that extent limits and restricts the powers of the Board of Directors in the following matters:

- a. increases and decreases in the size of the faculty.
- b. to add or discontinue courses in the curriculum.
- c. fixing the amount of tuition to be paid by and for pupils of the school(s).
- d. the right to approve or disapprove the incurring of any extraordinary liabilities.
- e. the authority to approve or disapprove the sale of real estate.

ARTICLE II Meetings

Semi-annual meetings of the Association shall be held in Spring and Fall . The Spring meeting shall be designated as the Annual Meeting. The Fall meeting shall be an area meeting at which meeting the Board of Directors will be elected. The exact date shall be set and announced by the Board of Directors. Special meetings may be called by the Board of Directors.

The Board of Directors shall meet quarterly, or more frequently if necessary.

ARTICLE III Finances

This Association shall be financed by contributions, donations and student fees. All monies shall be placed into a checking and/or savings account as designated by the Board of Directors. Should at any time this Association be dissolved, its monies shall be donated to the CHURCH EXTENSION FUND of the Wisconsin Evangelical Lutheran Synod.

ARTICLE IV Duties of the Officers

Chairman - The Chairman shall preside over all the meetings of the Association and the Board of Directors. He shall see to it that all of its resolutions and responsibilities be carried out, appoint Chairman of committees, and see to the proper functioning at each meeting.

Vice-Chairman - The Vice-chairman shall perform all the duties of the chairman during the absence or at his request. The Vice-chairman shall present all requests, memorials, and reports to the Pacific Northwest District.

Secretary - The Secretary shall keep an accurate and permanent record of all meetings of the Associations and of the Board of Directors, attend to all its correspondence, keep an accurate membership list and make all notifications of meetings. The Secretary shall also send a copy of all minutes to each congregation in the Pacific Northwest District, to those sister congregations having members in the Association, and to each supporting member of the Association.

Treasurer - The Treasurer shall keep an accurate account of all receipts and disbursements, pay all bills, make quarterly financial reports and make the proper deposits in the bank approved by the Board of Directors. The Treasurer's books shall be audited annually by a committee appointed by the chairman.

ARTICLE V Order of Business

Roberts's Rules of Order shall govern all proceedings of all

meetings of the Association and the Board of Directors.

ARTICLE VI Supervision

The Association and its Board of Directors shall be subject to the supervision and guidance of the Pacific Northwest District Board for Parish Education; the Chairman of which shall be an ex-officio member of the Board of Directors;

ARTICLE VII Amendments

These By-Laws may be amended by a majority of votes cast, provided that a written notice of the proposed amendment has been supplied to the members of the Association sixty (60) days prior to the meeting at which the proposed amendment is to be voted upon. Written ballots, validated by the Secretary, will be accepted prior to the scheduled meeting.

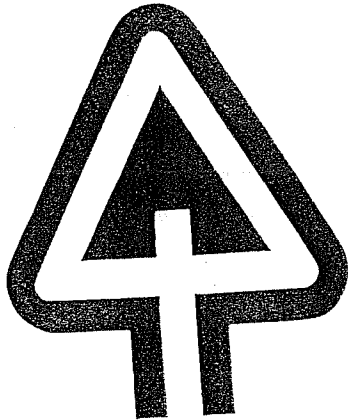
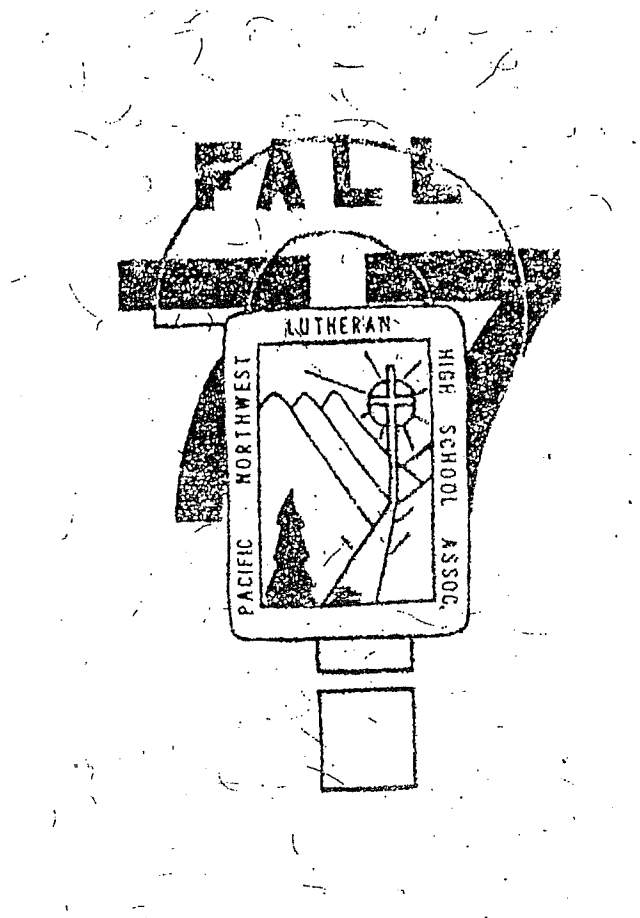

Designed by Scott Hamilton

"There is some obvious symbolism in the ELHS logo, along with some subtleties. Usually the observer will notice the evergreen tree and the cross immediately. After more consideration you will notice that the triangle represents the Trinity and the entire logo resembles a one way sign, Jesus being the one way to heaven. Since Evergreen is a fresh young school with a clear outlook on the future, I wanted the logo to be a simple, clean, crisp graphic device."

DUPONT SCHOOL



To DuPont
(town)



Our exclusive use - 14,400 sq. ft.

To Tennis Courts



Joint use with other tenants - 8,600 sq. ft.
(others - 40 days per year)



Joint use with City College - 2,500 sq. ft.
(City College - evenings only)



Leased exclusively by others

To Football/Track Field

To Baseball/Softball Field

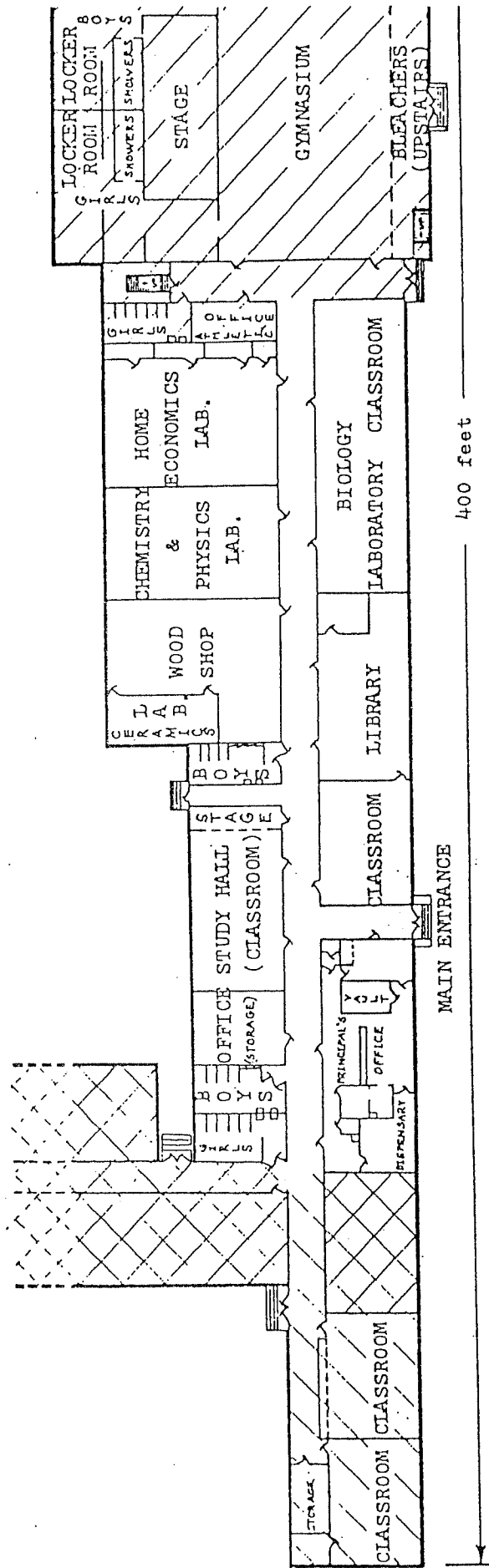

DuPont Exit

South to Portland



North to Tacoma/Seattle
17 minutes to Faith or Parkland Church

HAPPY NEW YEAR

Harner

Dunn

Barbara

Edward

Mark Tacke

Shon Smith

Walter

Renée

Ellen McCullough

Mike Saboury

Flinda Dwick

Jim D.

FROM ALL OF US AT

EVERGREEN LUTHERAN

HIGH SCHOOL...

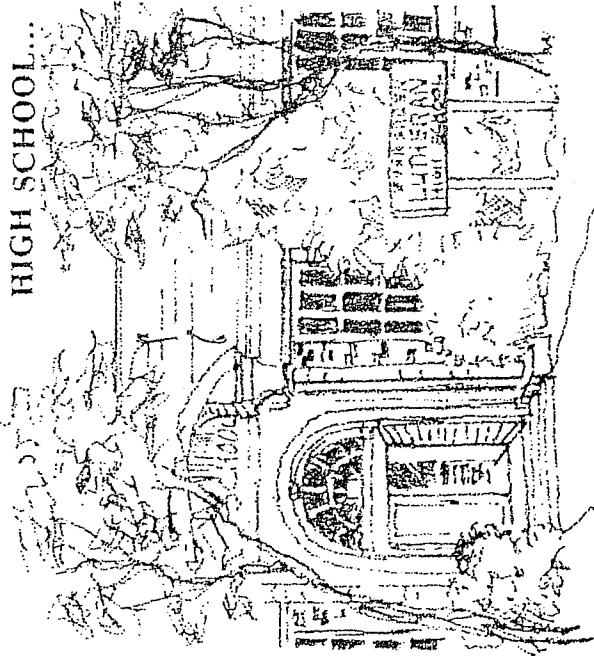

John B. Blomquist

Tristan Hochmann

Mark Tacke

Ed Blomquist

Chalotte
Pasbarger

Ernst Wof

Ernest Morgan

Randy Ottom

Ernesta Stout

Linda Albert

Brian Easley

Jerry Soprati

Debra Steffen

Azula Hubbard

Craig Henderson

May 1, 1985 Update

An Open Letter to the WELS/ELS Christians of the Pacific Northwest

Dear Friends and Co-Workers in the Lord's Kingdom,

Each month I receive the newsletters and school papers of many of our area Lutheran high schools. I do not take the time to read each article carefully. In most cases I just skim through them. I often find many items of interest but I am sure that I also miss much good information. If you have a lot of things to read and a busy schedule to carry out, perhaps you also shun most of your reading material--the UPDATE included.

A Favor To Ask

Please do not skim this article. I have some serious thoughts which I would like to share with you. These thoughts need your study and reaction so that Christian education on the secondary level in our midst will not be hindered.

Person To Person

I cannot reach each of you personally so I have chosen the next best way. I will write a letter to my Christian friends and let them know how things are going at Evergreen Lutheran High School. I will dispense with the usual discussion of the weather and personal health remarks. Suffice it to say that it does rain at ELHS but it doesn't interrupt the normal functions of a school; the Lord has blessed the health of the students and faculty.

Clay

Some of you heard me say or will hear me tell you that people are like clay. What we hear, see, taste and touch influences our lives. Young people even more so are affected by what is going on around them. When children are little we can protect them from harm and carefully guard what factors are influencing their lives. However, as the children grow older, we are often not able to keep up this wall of protection. Our children are going to be influenced; the question is, "By whom...What will be the influence?" It's for that reason that ELHS was begun in 1978. At ELHS the students can continue to grow under the same influence begun in them by their Christian parents and strengthened by their Christian teachers and pastor.

While we are on earth we will not find a place where God's will is carried out in a perfect manner. Nevertheless, with God's help ELHS does offer its students an opportunity to learn more about their Lord and Savior, and witness the loving hand of God in each school day. The students are also taught those classes which will make them good citizens of this world. How well ELHS is doing in carrying out its goals and objectives may never be fully known. We do know that our students have gone on to the colleges or universities of their choice, entered the military or the job market and in general have used the talents which their Lord has given them.

Scriptures

From the Scriptures we have learned that each parent is held responsible (the father especially) for the Christian education of the child. In America we have become quite affluent and have developed the tradition of having teachers who can spend full time educating our children. This is not a "bad" custom, but there are dangers connected with it. When the Lord placed into our care the life of a child, He wanted us to not only care for its bodily needs but also the child's spiritual needs.

lives on after death, we will want to do everything to see to it that that soul lives on eternally in heaven. For that reason Christian people have grouped together to form Christian congregations and have called Christian men to be shepherds of those flocks so that their spiritual care will be well taken care of. Because feeding the sheep of our Lord and the lambs of our Lord often requires special talents, these Christian congregations have called people specially trained to feed Christ's lambs. The feeding of Christ's lambs dare not stop at eighth grade but must continue throughout the formative teen-age (high school) years of the young Christian.

Special Teachers

We know that it would be difficult to work an eight-hour job and then come home and teach a child everything he needs to know so that he can get along in this sophisticated, technical world. Special teachers are once again needed to teach Christ's lambs. Men and women who can give full time to teaching high school level courses must be called to instruct our children. Detailed programs of instruction must be worked out and special classroom equipment must be gathered so that our children will be prepared for their future life as Christian adults. All this is too much for one person or even a single congregation to financially afford and still give faithful attention to spreading the Gospel to all creatures.

When a group of Christians pool their God-given resources, elementary Christian education can be provided the young lambs of Christ. When these groups of Christians join together with other Christian congregations, Christian education on a higher level (high school) can be carried out.

Guard Against Loss

I have been told that not too many years ago young children would use the Ellensburg blue agate in their sling shots because they did not realize the value of such a stone. Today an "Ellensburg blue" is a thrill to find and a gift to cherish.

Is there a danger that in the hustle and bustle of this very busy world we might not fully appreciate the blessing of Christian education as we have it?

You see dear friends, Christian education is not just for you and me, for our sons and daughters. Where would we be had our parents or their parents before them, not had the pure Word of God taught to them? Where will our grandchildren or the generation coming after them be if we do not preserve for them the Word of God in its truth and purity? I have often heard Pastor Teske say, "We are just one generation away from losing the gospel, if we don't teach it carefully to our children." God has entrusted us, not the angels, with the most precious gift the world has or ever will have, His Holy Word. How we use this gift will have eternal consequences.

Area High Schools

In the early years of our churches' history, it was wisely deemed necessary to establish schools for the training of our pastors and teachers. Over the years the Lord has richly blessed these training schools. There is, however, something missing if all we do is see to it that our pastors and teachers receive this special opportunity to attend a school where all the classes are taught from a Christ-centered viewpoint. What about the students who want to become something other than full-time workers in the church? Wouldn't they too benefit from these special Christ-centered schools? The answer must be a resounding Yes! For that reason in 1903 the people in

Milwaukee, Wisconsin, joined together to establish a Christian high school where their sons and daughters also could learn more about Jesus their Savior. From that humble beginning Wisconsin Lutheran High School has become the largest Lutheran high school in the United States and the idea of area Lutheran secondary Christian education has spread throughout the Wisconsin Evangelical Lutheran Synod. Today there are 18 area Lutheran high schools giving the youth of our synod an opportunity to take classes where their faith need not be compromised as they study to become good citizens of this world.

Evergreen

I vividly recall the meeting, held at Grace, Yakima, where it was voted to begin such an area Lutheran high school in our own midst. It was decided that the majority of "our people" lived over "on the coast" and so Evergreen Lutheran High School was begun in the building vacated by the Steilacoom School District in DuPont, Washington. What a blessing this area Lutheran high school has been for the people in the Pacific Northwest. It has been a special blessing for me personally. I can send my high school age children to a school where the goals, objectives and religious philosophies of the instructor are identical to those of my wife and I. I can attend the special concerts, and watch the various athletic events and at the same time be able to share in the growing up of my children.

Evergreen Lutheran High School has been blessed with friends who are deeply concerned about the Christian education of our youth. These friends have given wonderful gifts of love to the Lord through ELHS in the form of money, time and gifts. May the Lord bless them with the knowledge that they have done it unto Him.

At this time Evergreen Lutheran High School needs more of your HELP (Help Evergreen Live Permanently). The thought has been suggested that it may not be wise stewardship to HELP at this time. It might be better if one waits until Evergreen is "on its feet" so to speak. While I can appreciate that type of concern, I do believe that we dare not implement such action. Evergreen needs a continual monthly support or else it cannot pay its various bills. Each month that we don't reach our goal of about \$15,000 in member support, we slip a little further into debt.

We each have our God-given areas of responsibility. We each have a loving God who knows our inmost wants and needs. We each have a merciful God who will not let us suffer want because our love for Him has prompted us to spread His Word.

HELP - The cry goes up once again. Will you HELP?

Many blessings of the Lord will continue to happen at ELHS during the months of May and early June. For that I thank God and you for your help. Please continue to do so.

In Christ's name,

Werner Lemke

Werner Lemke, Principal

Dear Father in heaven,

I need a few moments, a few moments to thank you for Evergreen Lutheran High School. I need to thank you for allowing two of my children to have graduated from ELHS, for all the care, love and concern shown all our children.

Father, sometimes we "out west" feel isolated, but with Evergreen we are beginning to build a focal point for all of us, where we can unite in song and fellowship, strengthening our faith.

Lord, you know the struggles we've had and you've been there to help us with all of them. Guide us now God, please! Help all of us realize we must keep Evergreen, help us know that whether we have sons or daughters at this school, or whether that time is past or yet to come we are responsible for all our youth. You have given us this command in your Word, let us hear and be responsible to your call.

You have been so gracious, help us remember that. Keep our sinful hearts from doubt and remind us of your presence. Help us remember that whatever our need, we have only to ask and you hear and answer. Thank-you for allowing me to come to you with all my fears and then giving me strength and renewing my trust. Take care of us God, take care of our school! Amen

(Attached words)I know too little of our situation of purchasing our present building and wish I could be with you but my family is ill so..... I know we need our school. I know it serves God's kingdom and so I ask a prayer and share it with you. Whatever your decision my family and I will work for Evergreen.

God bless,
Barb Nollmeyer

Faculty and Staff of Evergreen Lutheran High School

1978-79 Dupont

Principal Wayne Baxmann
Rev. Richard Wiechmann
Mark Tacke

Tom Dobberstein (Coach)
Mrs. Joanne Eskew (Secretary)
Mrs. Margie Mankin (Art)
Mrs. Yvonne McCullough (Economics)
Mr. Thom Naumann (Architectural Drawing)

1979-80 Dupont

Principal Wayne Baxmann
Rev. Richard Wiechmann
Rev. Mark Bartsch
Ed Mawe
Tom Schwartz

Tom Dobberstein (Coach)
Mrs. Joanne Eskew (Secretary)
Nancy Schwartz (Typing)
Debbie Bryant (Bus driver)
Mrs. Joan Harstad (Piano)
Mrs. Phyllis "Grandma" Woodley (Cook)

1980-81 Dupont

Principal Wayne Baxmann
Rev. Richard Wiechmann
Ed Mawe
Tom Schwartz
Jack Gronholz

1981-82 Dupont

Principal Wayne Baxmann
Rev. Richard Wiechmann
Tom Schwartz
Barb Jacobson
Jack Gronholz

1982-83 Dupont

Principal Wayne Baxmann
Rev. Richard Wiechmann
Tom Schwartz
Barb Jacobson
Jack Gronholz

1983-84 Dupont

Principal Wayne Baxmann
Tom Schwartz
Barb Jacobson
Jack Gronholz
Rev. William Stuebs
Mike Schaeffer
Paul Danuser

1984-85 Dupont

Principal Werner Lemke
Tom Schwartz
Barb Jacobson
Jack Gronholz
Rev. William Stuebs
Paul Danuser
Nate Sebald
Heidi Sebald

1985-86 Dupont

Principal Werner Lemke
Tom Schwartz
Barbara Jacobson
Rev. William Stuebs
Nate Sebald
Mike Oesch
Tim Tahaney
Delcia Fudge

Mrs. Joan Harstad (Piano)
Mrs. Joyce Grizzell (Accountant)
Mrs. Heidi Sebald (Girls dorm/librarian)
Mrs. Betty Young (Bus Driver)
Mrs. Marge Ellenberger (Cook)

Mrs. Peggy Edman (Cook)
Dr. Robert Knapp (Coach)

1986-87 Dupont

Principal Werner Lemke
Tom Schwartz
Rev. William Stuebs
Nate Sebald
Mike Oesch
Tim Tahaney
Delcia Fudge
Brent Schacht
Karen Schacht
Kenneth Borchert

Mrs. Joan Harstad (Piano)
Mrs. Heidi Sebald (Girls dorm/librarian)
Mrs. Marge Ellenberger (Cook)
Mrs. Peggy Edman (Cook)
Dr. Robert Knapp (Coach)
Cindy Mack (Bus Driver)
Kathy Borchert (Janitor)
Alice Keen (Bookkeeper)

1987-88 Dupont

Principal Werner Lemke
Tom Schwartz
Rev. William Stuebs
Barbara Jacobson
Delcia Fudge
Kenneth Borchert
Judy Lemke
Steve Fritze
Jeff Roloff
Sarah Roloff
Mrs. Joan Harstad (Piano)
Mrs. Marge Ellenberger (Cook)
Mrs. Peggy Edman (Cook)
Dr. Robert Knapp (Coach)

Kathy Borchert (Janitor)

1988-89 Kent

Principal Werner Lemke
Tom Schwartz
Rev. William Stuebs
Kenneth Borchert
Judy Lemke
Molly Newsam (Secretary)
Sharon Laabs (Piano)

1988-89 Kent

Principal Werner Lemke
Tom Schwartz
Rev. William Stuebs
Kenneth Borchert
Judy Lemke
Molly Newsam (Secretary)
Sharon Laabs (Piano)

1988-89 Kent

Principal Werner Lemke
Tom Schwartz
Rev. William Stuebs
Kenneth Borchert
Judy Lemke
Molly Newsam (Secretary)
Sharon Laabs (Piano)

1989-90 Kent

Werner Lemke
Rev. William Stuebs
Kenneth Borchert
Kathy Borchert (Yearbook advisor)
Tom Quick
Diane Quick
Rev. Douglas Weiser (Administration)
Karen Schacht

Molly (Newsam) McLeish (Secretary)
Sharon Laabs (Piano)

1990-91 Kent

1991-92 Kent

Principal Jon Schoeneck
Werner Lemke
Rev. William Stuebs
Kenneth Borchert
Nathan Walworth
Lisa Vogel
Molly (Newsam) McLeish (Secretary)??
Sharon Laabs (Piano)
Dennis Gentele (Janitor)
Pat Gentele (Bookkeeper)

1992-93 Kent

Principal Jon Schoeneck
Werner Lemke
Rev. William Stuebs
Kenneth Borchert
Nathan Walworth
Debbie Walworth
Lisa Vogel
Steph Rodmyre
Jeff Kurbis
Mrs. Davisson (Secretary)
Sharon Laabs (Piano)
Dennis Gentele (Janitor)
Pat Gentele (Bookkeeper)

1993-94 Kent

Principal Jon Schoeneck
Werner Lemke
Rev. William Stuebs
Nathan Walworth
David Habeck
Lisa Vogel
Jeff Kurbis

Margie Owens (Secretary)
Sharon Laabs (Piano)
Dennis Gentele (Janitor)
Pat Gentele (Bookkeeper)

1994-95 Kent

Principal Jon Schoeneck
Werner Lemke
Rev. William Stuebs
David Habeck
Lisa Vogel
Jeff Kurbis
Mark Tacke (Any relation to first one?)
Rev. Jon Buchholz
Mrs. Jeanelle Herrel
Margie Owens (Secretary)
Sharon Laabs (Piano)
Dennis Gentele (Janitor)
Pat Gentele (Bookkeeper)

1995-96 Kent

Principal Jon Schoeneck
Werner Lemke
Rev. William Stuebs
David Habeck
Lisa Vogel
Jeff Kurbis
Mark Tacke (Any relation to first one?)
Rev. Jon Buchholz
Mrs. Jeanelle Herrel
Margie Owens (Secretary)
Sharon Laabs (Piano)
Dennis Gentele (Janitor)
Pat Gentele (Bookkeeper)
Deb Schoeneck (Secretary)
Mrs. Rachel Tacke (Art)

1996-97 Kent

Principal Jon Schoeneck
Werner Lemke
Rev. William Stuebs
David Habeck
Lisa Vogel
Jeff Kurbis
Mark Tacke (Any relation to first one?)
Rev. Jon Buchholz
Rev. David Laabs
Mel Loukes
Jeff Stellick
Margie Owens (Secretary)
Sharon Laabs (Piano)
Dennis Gentele (Janitor)
Pat Gentele (Bookkeeper)
Deb Schoeneck (Secretary)
Mrs. Rachel Tacke (Art)

1997-98 Kent

Board of Directors PNLHSA

Board of Directors 1975

Western Washington

Teacher Jon Schoeneck (Bellevue)
Teacher John Rittierodt (Tacoma)
George Egerter (Puyallup)
Bruce Walden (Bellevue)
Clayton Julien (Renton)

Eastern Washington

Pastor Arthur Valerio (Yakima)
Pastor Melvin Teske (Yakima)
Teacher Tom Marten (Yakima)
John Pietrusiewice (Pasco)
Gary Nelson (Yakima)

Oregon/Idaho

Pastor Ethan Kahrs (Bend)
Pastor Gerald Ditter (Portland)
Teacher Arnold Goodger (Bend)
Dave Baker (Portland)
Jon Majovski (Newburg)

Non voting representatives from the ELS

John Hokanson (Port Orchard)
Craig Owings (Tacoma)

Rev. Paul Albrecht-District Board for Parish Education

Board of Directors 1976

Chairman: A. Valerio (Yakima)

Vice Chairman: Tom Marten (Yakima)

Secretary: A. Goodger (Bend)

Treasurer: G. Egerter (Puyallup)

Western Washington

Teacher Jon Schoeneck (Bellevue)
Teacher John Rittierodt (Tacoma)
Bruce Walden (Bellevue)
Clayton Julien (Renton)

Eastern Washington

Pastor Melvin Teske (Yakima)
John Pietrusiewice (Pasco)

Gary Nelson (Yakima)
Oregon/Idaho
Pastor Ethan Kahrs (Bend)
Pastor Gerald Ditter (Portland)
Dave Baker (Portland)
Jon Majovski (Newburg)
Non voting representatives from the ELS
John Hokanson (Port Orchard)
Craig Owings (Tacoma)
Rev. Paul Albrecht-District Board for Parish Education

Board of Directors 1989

Chairman: Rev. Douglas Weiser
Vice-Chairman: Dr. August Gabert
Secretary: Rev. Carl Busse
Treasurer: Mr. Thomas R. (Jr.) Anderson
Financial Secretary: Mr. Michael Cram
Roc Cordes
John Pietrusiewicz
Rev. Darryl Bruemmer
Leslie (Les) Perry
Rev. Glenn Obenberger
Stephan Rodmyre
Robert Elhard
Rev. Gerald Ditter
Mark Williams
Lance Hartzell
Terry Besel
Ex-Officio: Werner Lemke, David Sauer, Rev. Warren Widmann

Board of Directors 1990

Chairman: Rev. Douglas Weiser
Vice-Chairman: Dr. August Gabert
Secretary: Rev. Carl Busse
Treasurer: Mr. Thomas R. (Jr.) Anderson
Financial Secretary: Mr. Michael Cram
Rev. Darryl Bruemmer
Leslie (Les) Perry

Rev. Glenn Obenberger
Stephan Rodmyre
Robert Elhard
Rev. Gerald Ditter
Mark Williams
Lance Hartzell
Thomas (Jeff) Mankin
David Negrey
Gene Rubbert
Harry Goodwin
David Teske
Douglas Guelker
Ex-Officio: David Sauer, Rev. Warren Widmann

Board of Directors 1991

Chairman: Rev. Douglas Weiser
Rev. Darryl Bruemmer
William Hartwig
Les Perry
Robert Elhard
David Negrey
Gene Rubbert
August Gabert
Gary Gray
Rev. Homer Mosley
Stephan Rodmyre
Jeff Mankin
Lance Hartzell
Dave Teske

Board of Directors 1992

Douglas Guelker
Stephan Rodmyre
Stanley Cole
Curtis Mantey
Robert Elhard
Jeff Mankin
Gary Gray
Ron A. Stennes

Rev. Darryl Bruemmer
Dr. August Gabert
William Hartwig
David Stulmiller
Dale Gray
David Teske
Gene Rubbert
Ex-Officio: Rev. Warren Widmann, Jonathon Schoeneck, David Sauer

Board of Directors 1994

Chairman: Stephan Rodmyre
Vice Chairman: Curtis Mantey
Secretary: Ronald Stennes
Treasurer: John Weed
Financial Secretary: Gary Gray
Jeff Mitchell
Stan Cole
Dale Gray
Rev. Jeffrey Carter
Ex-Officio: Rev. Warren Widmann, David Sauer, Jonathon Schoeneck, Rev.
Douglas Weiser